

1 SECOND FLOOR PLAN - AREA "D"  
SCALE: 1/8" = 1'-0"

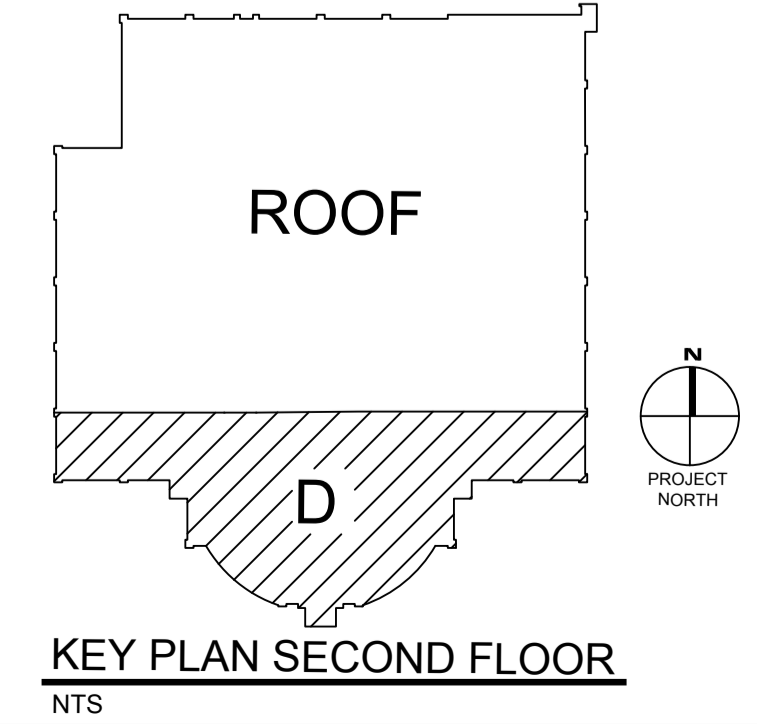
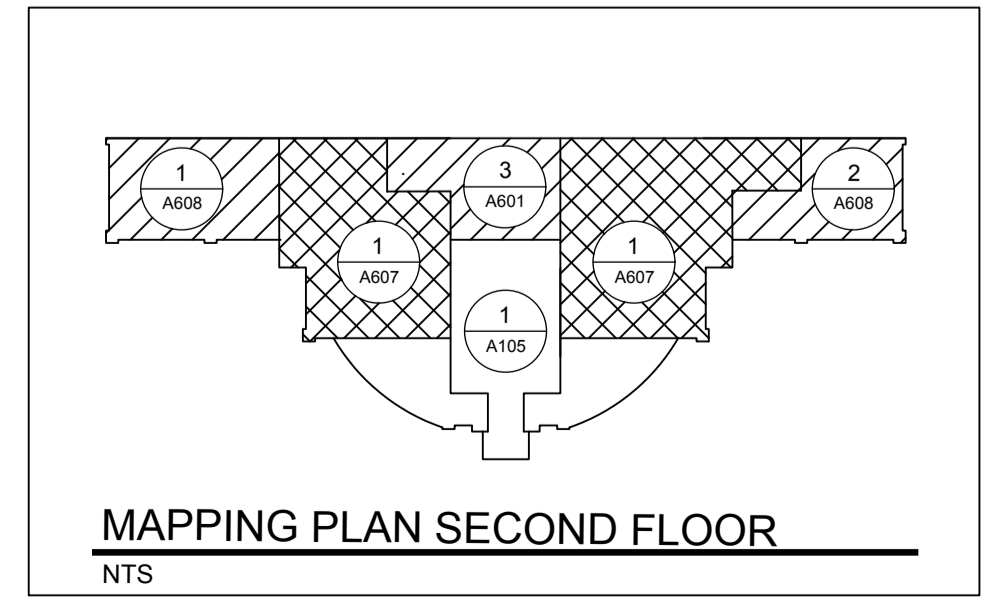

| NO. | DATE | REMARKS | NO. | DATE | REMARKS |
|-----|------|---------|-----|------|---------|
|     |      |         |     |      |         |
|     |      |         |     |      |         |
|     |      |         |     |      |         |
|     |      |         |     |      |         |

LEGIBILITY: I AM NOT A LICENSED ARCHITECT OR ENGINEER IN THE STATE OF MARYLAND.  
KERRI WOODLUM, INC. 2027  
LAPPORTER@KERRIWOODLUM.COM

ARCHITECTURE  
ENGINEERING  
INCORPORATED  
**IOTT**  
310 HAMMOND ST. SUITE 100 SALISBURY, MARYLAND  
(410) 749-7229 • FAX (410) 749-0001

TRI - COUNTY MULTI-PURPOSE CENTER  
BUILDING ENVELOPE AND  
INTERIOR RENOVATION  
SALISBURY, MARYLAND  
SECOND FLOOR PLAN - AREA "D"

PRINT DATE: 11.12.2010  
IOTT PROJ. NO.: 09-035  
DESIGN BY: KI  
DRAWN BY: EJM  
SCALE: AS NOTED  
STAGE: ISSUED FOR BID  
DWG. FILE: 09-035-A-104

**A**  
**104**